



## INSTALLATION, PRECAUTIONS & SERVICING



V2 Jan 2026

# IMPORTANT

- Please bear in mind the weight of the fire before removing from the packaging and installation.
- Consider if help is required.
- Carefully remove the fire from the packaging, making sure that the power cable and heater have not been damaged during transport.
- **DO NOT** operate the fire if damaged.
- The accessories are found in a box that is packed at the side of the fire.
- Always read this manual first before attempting to install or use and keep in a safe place.
- Your fire is guaranteed for three years from the date of purchase.\*
- \*Northern Ireland - 1 Year Only



**IMPORTANT  
SAVE THESE  
INSTRUCTIONS**

---

# CONTENTS

Important Instructions..... 4

UKCA & CE Declarations..... 7

Details..... 8

Technical Specifications..... 9

Required Tools..... 10

What's In The Box..... 11

Before You Start..... 12

1, 2 & 3 Sided Installation..... 13

Flat Wall Installation..... 14

Stud Wall Installation..... 18

Informational Requirements..... 23

Trouble Shooting..... 24

Wiring Diagram..... 26

Cleaning & Maintenance..... 27

Exploded Diagram..... 28

Parts List..... 29

Notes..... 30

# IMPORTANT INSTRUCTIONS

## IMPORTANT

### REGISTRATION NO WEE/DH1656ZW

- In accordance with European Directive 2012/19/ EU, waste electrical and electronic equipment (WEEE) must not be disposed of with household waste.
- Please recycle responsibly.



## DETAILS

- Read all the instructions before installing or using this heater.
- **WARNING:** In order to avoid overheating, do not cover the heater.
- For indoor use only.
- **DO NOT** use the fire in the vicinity of a bath, shower or swimming pool.
- **NEVER** use the fire to dry laundry.
- The heater must not be located immediately below a socket outlet.
- The use of an extension lead is **NOT** recommended.
- This appliance can be used by children aged from 8 years and above and persons with reduced physical, sensory or mental capabilities or lack of experience and knowledge if they have been given supervision or instruction concerning use of the appliance in a safe way and understand the hazards involved.
- Children shall **NOT** play with the appliance



---

# IMPORTANT INSTRUCTIONS

- Cleaning and user maintenance shall **NOT** be made by children without supervision.
- Children of less than 3 years should be kept away unless continuously supervised.
- Children aged from 3 years and less than 8 years shall only switch on/off the appliance provided that it has been placed or installed in its intended normal operating position and they have been given supervision or instruction concerning use of the appliance in a safe way and understand the hazards involved.
- Children aged from 3 years and less than 8 years shall not plug in, regulate and clean the appliance or perform user maintenance.
- Some parts of this product can become very hot and cause burns. Particular attention must be given where children and vulnerable people are present.
- The heater is hot when in use. To avoid burns, do not let bare skin touch hot surfaces. Keep combustible materials, such as furniture, pillows, bedding, paper, clothes, etc. and curtains at least 3 feet (0.9m) from the front of the heater and keep them away from the sides and rear (sides and rear restrictions apply to location dedicated heaters only).
- Extreme caution is necessary when any heater is used by or near children or invalids and whenever the heater is left operating and unattended.
- **Do not** operate any heater after it malfunctions. Disconnect power at service panel and have heater inspected by a reputable electrician before reusing.
- **Do not** use outdoors.
- To disconnect heater, turn controls to off and turn off power to heater circuit at main disconnect panel.
- **Do not** insert or allow foreign objects to enter any ventilation or exhaust opening as this may cause an electric shock or fire, or damage to the heater.
- To prevent a possible fire, **do not** block air intakes or exhaust in any manner.
- A heater has hot and arcing or sparking parts inside. **Do not** use it in areas where gasoline, paint, or flammable vapour or liquids are used or stored.
- Use this heater only as directed in this manual. Any other use not recommended by the manufacture may cause fire, electric shock, or injury to persons.

# IMPORTANT INSTRUCTIONS



**CAUTION**

**CAUTION  
RISK OF ELECTRIC SHOCK**

**DO NOT OPEN  
NO USER-SERVICEABLE PARTS INSIDE**



- The heater must be properly installed before it is used.
- Caution should be applied to ensure that children **DO NOT** play with the fuel effects.
- As with any electrical appliance whilst the instructions aim to cover as many eventualities as possible, caution and common sense should be applied when operating your appliance, particularly in the vicinity of small children.
- **CAUTION:** The heater is fitted with an automatic cut out to prevent any damage due to overheating. The element will continually and automatically cut out if the airflow is obstructed. Never cover the air outlets. To reset, switch the fire off, disconnect from the main supply, remove the cause of the overheating. Allow to cool for a suitable period then switch the fire back on.
- **CAUTION:** In order to avoid a hazard due to inadvertent resetting of the thermal cut out, the appliance must not be supplied through an external switching device, such as a timer, or connected to a circuit regularly switched on and off by a utility.
- 2.4 GHz network required.

# UKCA & CE DECLARATIONS

TRADE NAME	RATINGS	PRODUCT TYPE	MANUFACTURED BY
E-FX	220-240 Vac, 50Hz Class I	Electric Fire (fan heater) (5120 BTU)	Flamerite Fires LTD. Greenhough Road, Lichfield. Staffs. WS13 7AU. United Kingdom.
REQUIREMENTS:			
BS-EN 60335-2-30:2009 + A11:2012			
BS-EN 60335-1:2012 + A11:2014 + A13:2017 + A1:2019 + A14:2019 + A2:2019			
BS-EN 55014-1:2017		BS-EN IEC 6300 :2018	
BS-EN 55014-2:2015		BS-EN 301 489-1	
BS-EN61000-3-2:2014		BS-EN 300 489-3	
BS-EN 61000-3-3:2013		BS-EN 300 220	
BS-EN 50564:2011		BS-EN 60675:1995+A11:2019	
TRADE NAME	RATINGS	PRODUCT TYPE	MANUFACTURED BY
E-FX	220-240 Vac, 50Hz Class I	Electric Fire (fan heater) (5120 BTU)	Flamerite Fires LTD. Greenhough Road, Lichfield. Staffs. WS13 7AU. United Kingdom.
REQUIREMENTS:			
EN 60335-2-30:2009 + A11:2012			
EN 60335-1:2012 + A11:2014 + A13:2017 + A1:2019 + A14:2019 + A2:2019			
EN 55014-1:2017		EN IEC 6300 :2018	
EN 55014-2:2015		EN 301 489-1	
EN61000-3-2:2014		EN 300 489-3	
EN 61000-3-3:2013		EN 300 220	
EN 50564:2011		EN 60675:1995+A11:2019	

---

## DETAILS

- A 120V 60Hz 15A or 240V 50Hz 13A supply is required.
- Maximum Power Consumption: 1500 Watts (BTU: 5120)
- A 1.8 metre lead / 6 foot lead is supplied with this appliance.
- There must be enough clearance for the fire to comfortably fit inside or against a wall.
- **DO NOT** squeeze into an opening as this may deform the case.
- The fire must be well supported in or on any structure. Never secure to just plaster board alone.
- A wall support or lintel should be fitted at the required height to ensure the appliance does not support the weight of the finished wall or chimney breast.



### WARNING

DO NOT twist, force or squeeze the fire during the installation process.

# TECHNICAL SPECIFICATIONS

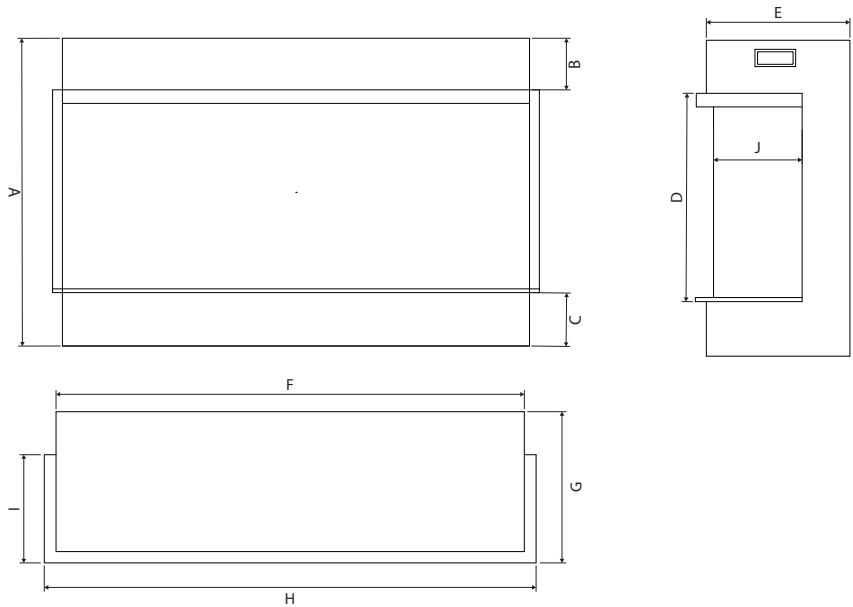

		E-FX MODEL			
		1000	1300	1500	1800
DIMENSIONS & WEIGHT	A	663mm / 26 1/8"	663mm / 26 1/8"	663mm / 26 1/8"	663mm / 26 1/8"
	B	110mm / 4 5/16"	110mm / 4 5/16"	110mm / 4 5/16"	110mm / 4 5/16"
	C	116mm / 4 9/16"	116mm / 4 9/16"	116mm / 4 9/16"	116mm / 4 9/16"
	D	437mm / 17 3/16"	437mm / 17 3/16"	437mm / 17 3/16"	437mm / 17 3/16"
	E	300mm / 11 13/16"	300mm / 11 13/16"	300mm / 11 13/16"	300mm / 11 13/16"
	F	1000mm / 39 3/8"	1300mm / 51 3/16"	1500mm / 59 1/16"	1800mm / 70 7/8"
	G	320mm / 12 5/8"	320mm / 12 5/8"	320mm / 12 5/8"	320mm / 12 5/8"
	H	1044mm / 41 1/8"	1344mm / 52 15/16"	1544mm / 60 13/16"	1844mm / 72 5/8"
	I	228mm / 9"	228mm / 9"	228mm / 9"	228mm / 9"
	J	188mm / 7 3/8"	188mm / 7 3/8"	188mm / 7 3/8"	188mm / 7 3/8"

---

## REQUIRED TOOLS



HAMMER &  
SCREWDRIVER

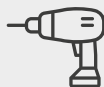

DRILL &  
DRILL BITS



TAPE MEASURE



PENCIL



SPIRIT LEVEL

---

## WHAT'S IN THE BOX...

01

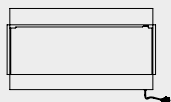

**E-FX FIRE**

02



**LOG SET**

03



**ACCESSORY PACK**

04



**DECORATIVE RAILS**

05

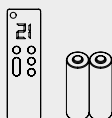

**REMOTE &  
BATTERIES**

06



**FIXING PACK**

07



**INSTRUCTIONS**

# BEFORE YOU START...

## PLUG SOCKETS

All fires must have an accessible plug. Do not fit a fire above a socket. Building regulations require the socket to be located at the side of the unit. It is preferable to fit the fire to a **120 VOLT** or **240 VOLT** switched grounded outlet for safety. This ensures it has its own supply and will not overload current installations.



### IMPORTANT

Please speak with a qualified expert before undertaking any work, and if required, ask them to carry out the installation for you.

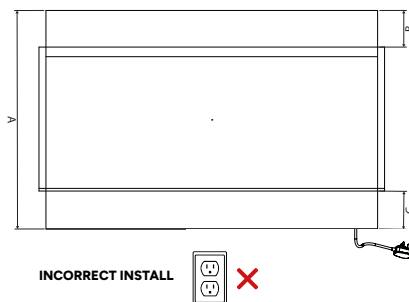

## WALL FASTENERS

If fixing the fire to a wall, please ensure suitable fasteners are used for the material the fire is being fixed to. Often the wall is not completely flat and the floor uneven. When hanging the fire be sure to take this into account to ensure a good solid fit that supports the fire safely. Your retailer may offer an installation service, or alternatively you can find a builder to fit the fire for you.

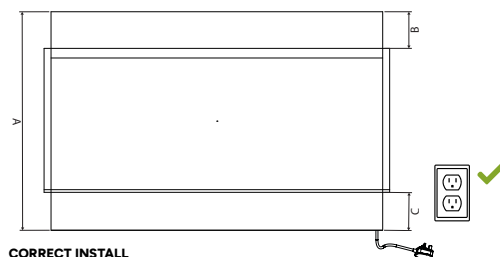



---

# 1, 2 & 3 SIDED INSTALLATION

The E-FX Range can be installed in three configurations: 1-sided (standard), 2-sided, or 3-sided. By default, the fire is supplied as a 1-sided model, with solid panels fitted on both sides. These can be removed to convert the fire to a 2 or 3-sided display.

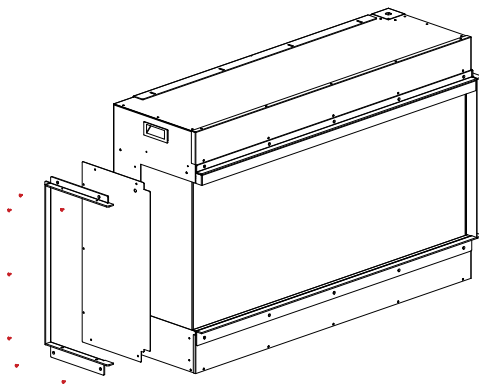

**01**

To remove the side trims, remove the 7 screws securing the side trims on the desired side and lift away the blanking panel to open the side.

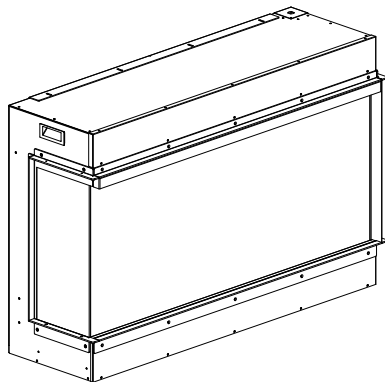

**02**

Refit the side trims back to the fire using the screws previously removed.

# FLAT WALL INSTALLATION

## FITTING YOUR E-FX FIRE ONTO A WALL OR INTO A STRUCTURE...

If purchased as a fire only or as a standard wall mount suite, the height at which you may wish to fix the fire in, or on the wall, is up to you. Be sure to take account of local building regulations, and if not sure, always consult a professional

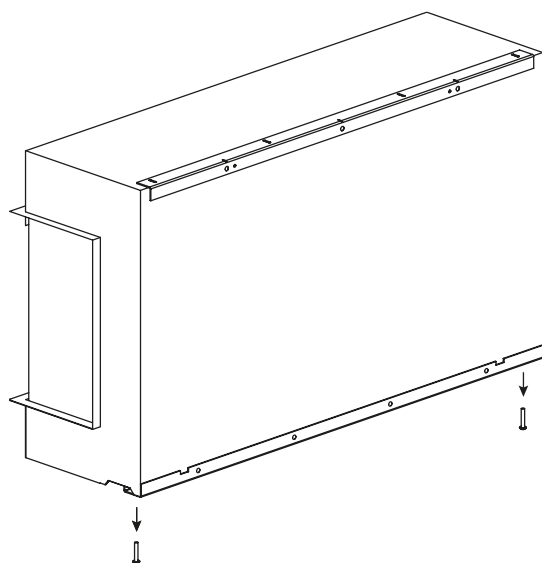

### 01

The lower bracket will have to be removed to begin the process.

Save the screws and washers for later.



**TIP**  
Save these!

# FLAT WALL INSTALLATION

BOTTOM RAIL FIXING HEIGHT TABLE	
PRODUCT	HEIGHT
1000	200mm / 7 7/8" Minimum
1300	200mm / 7 7/8" Minimum
1500	200mm / 7 7/8" Minimum
1800	200mm / 7 7/8" Minimum

## 02

Using a tape measure and level, mark the required height on the wall using the dimensions provided in the table above. The height is measured from the top of the bracket to the floor, as shown below. Mark where the centre of the rail is.

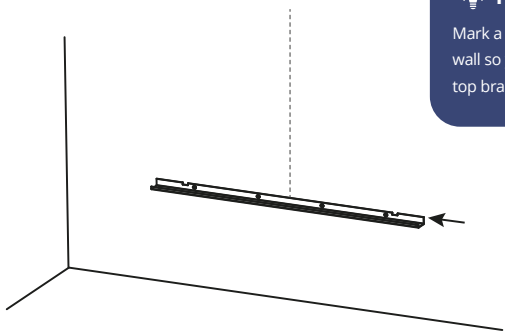

## 03

Drill the holes with a 10mm (3/8") drill bit and fit the wall plugs. Using the screws, secure the bracket to the wall.



### TIP

Mark a center line up the wall so you can align the top bracket.

BOTTOM RAIL FIXING TABLE				
FIXING	1000	1300	1500	1800
60mm / 2 3/8" Wall Screws	4	4	4	4
10mm / 3/8" Wall Plugs	4	4	4	4
M6 Screws	2	2	2	2
M6 Washers	2	2	2	2

# FLAT WALL INSTALLATION

TOP RAIL FIXING TABLE				
FIXING	1000	1300	1500	1800
60mm / 2 3/8" Wall Screws	4	4	4	4
10mm / 3/8" Wall Plugs	4	4	4	4
13mm / 1/2" Screws	2	2	2	2

## 04

Remove the top rail using a screwdriver and put the screws to one side. You will need them later. Using a measuring tape measure from the **TOP** of the **BOTTOM BRACKET**, to the **BOTTOM** of the **TOP BRACKET**, as shown below, aligning the centreline with the cut-out in the centre of the top bracket.

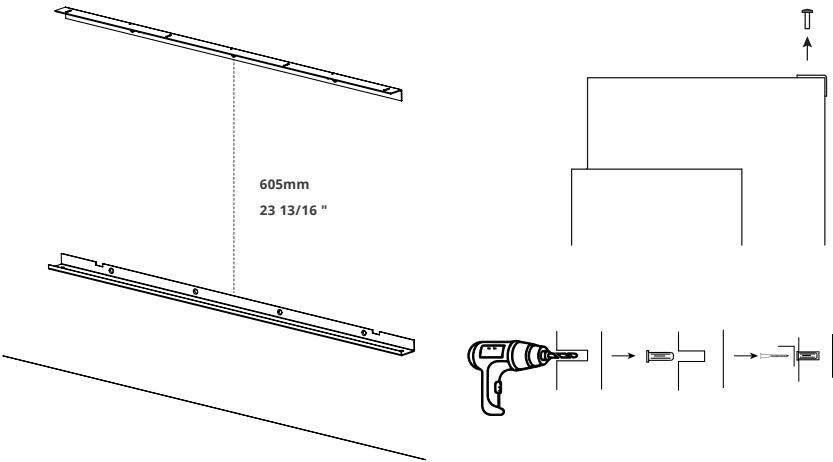

## 05

Drill the holes with a 10mm (3/8") drill bit and fit the wall plugs. Using the screws secure the bracket to the wall.

# FLAT WALL INSTALLATION

## 06

Next, using help if required lift the fire onto the bottom bracket and push firmly against both brackets. Use a drill or screwdriver to fix the fire to the top rail using the same screws that came with the bracket.

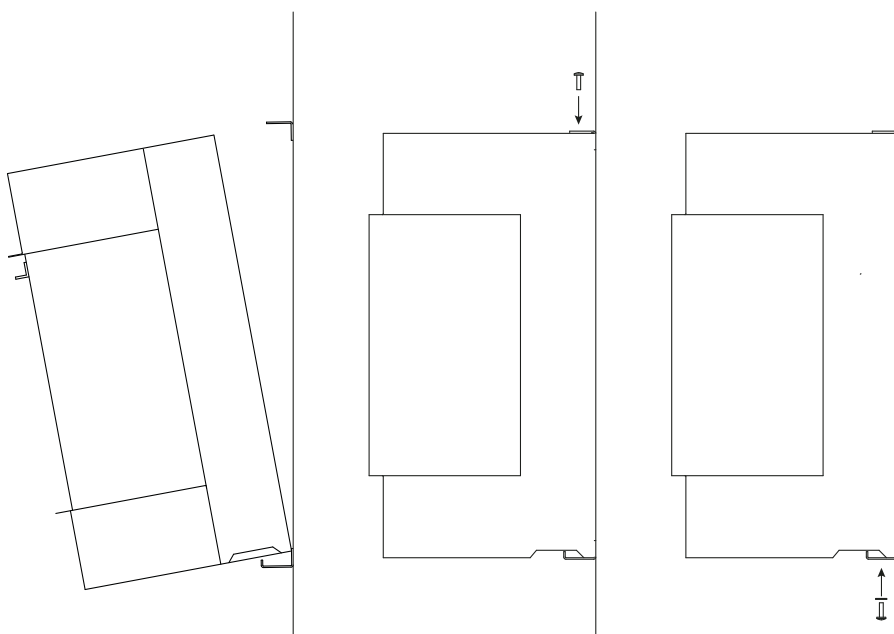

---

# STUD WALL INSTALLATION

## PRE-INSTALLATION NOTES

Use the tables to build your structure. You must install a header to make sure that the appliance does not support the weight of the finished wall. This is critical to smooth fitting and operation of the fire.

The fire should be placed on a stable, level surface in a clean, dust-free area. If installing the product into an open chimney or flue, make sure the chimney or flue is sealed off to prevent drafts and falling debris that could affect the product's airflow.

The power switch can not be hidden. It must have an easily accessible switch.

We recommend fitting the wall around the fire to allow for any manufacturing tolerances.

Any protruding headers must be made of a non combustible material.

**BEFORE FINISHING THE WALL MAKE SURE TO TEST THE APPLIANCE IS FULLY WORKING**

# STUD WALL INSTALLATION

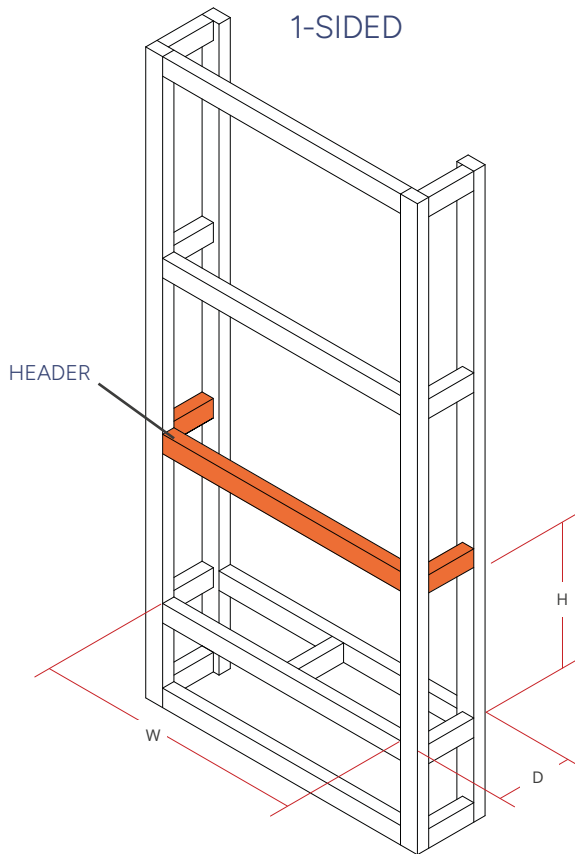

1 SIDED MINIMUM REQUIRED DIMENSIONS				
DIMENSION	1000	1300	1500	1800
Height (H)	665mm	665mm	665mm	665mm
Width (W)	1002mm	1302mm	1502mm	1802mm
Depth (D)	305mm	305mm	305mm	305mm

# STUD WALL INSTALLATION

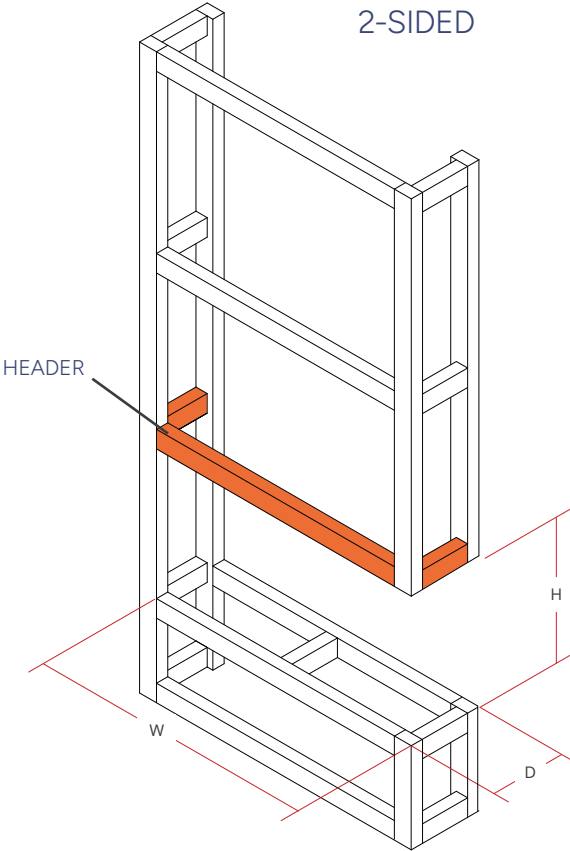

2 SIDED MINIMUM REQUIRED DIMENSIONS				
DIMENSION	1000	1300	1500	1800
Height (H)	665mm	665mm	665mm	665mm
Width (W)	1030mm	1330mm	1530mm	1830mm
Depth (D)	305mm	305mm	305mm	305mm



# STUD WALL INSTALLATION

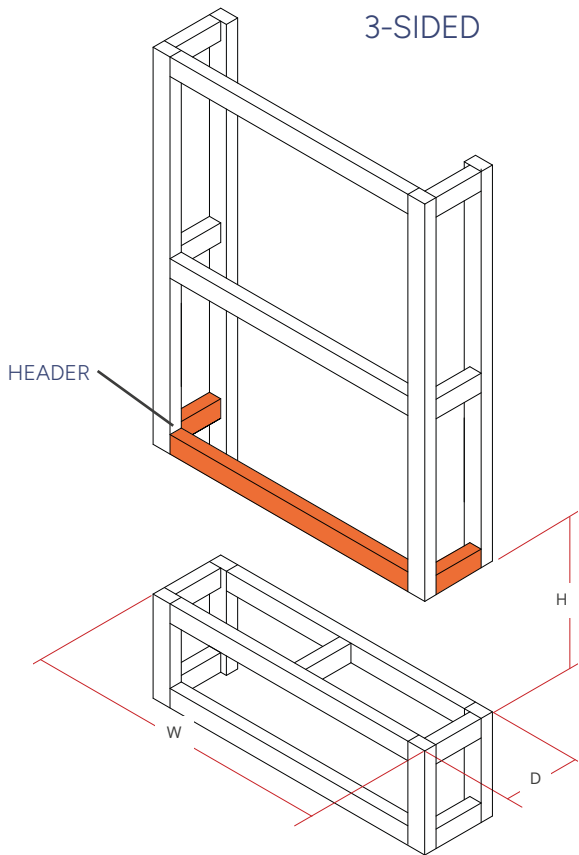

3 SIDED MINIMUM REQUIRED DIMENSIONS				
DIMENSION	1000	1300	1500	1800
Height (H)	665mm	665mm	665mm	665mm
Width (W)	1010mm	1310mm	1510mm	1810mm
Depth (D)	305mm	305mm	305mm	305mm

# STUD WALL INSTALLATION

## 01

Now the wall is built, remove the top bracket from the fireplace.

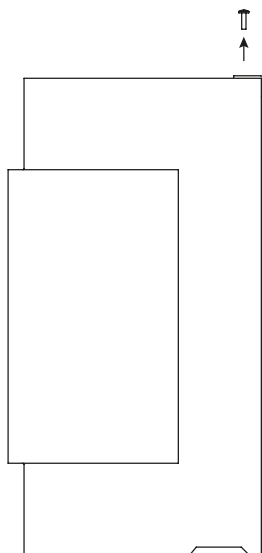

## 02

Slide the fire into the opening and position it where required.

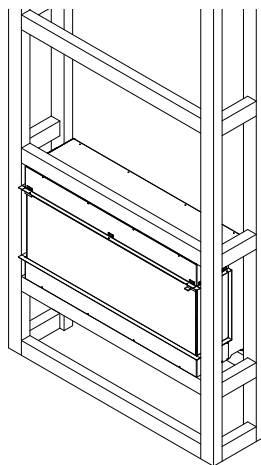

## 03

Finally turn the top bracket upside down, and fix it to the fire and the wall as shown. You can then finish the wall with your chosen construction. Remember any protruding headers must be non combustible.

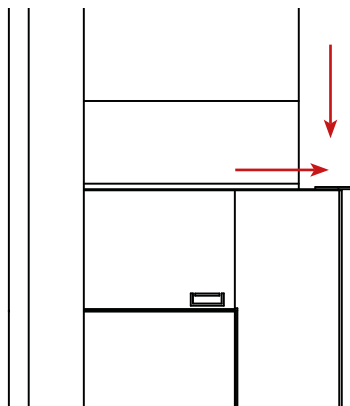

# INFORMATIONAL REQUIREMENTS

## E-FX

E-FX: INFORMATIONAL REQUIREMENTS FOR ELECTRIC LOCAL SPACE HEATERS						
MODEL		1000	1300	1500	1800	
Item @ 120V 60Hz or 240V 50Hz	Symbol	Value	Value	Value	Value	Unit
HEAT OUTPUT						
Nominal Heat Output	Pnon	1.5	1.5	1.5	1.5	kW
Minimum Heat Output (Indicative)	Pmin	0.75	0.75	0.75	0.75	kW
Maximum Continuous Heat Output	PMax,c	1.5	1.5	1.5	1.5	kW
AUXILIARY ELECTRICITY CONSUMPTION						
At Normal Heat	elmax	0.0312	0.0423	0.0537	0.0658	kW
At Minimum Heat	elmin	0.0312	0.0423	0.0537	0.0658	kW
In Standby Mode	elSB	0.0005	0.0005	0.0005	0.0005	kW

With Distance Control: Yes  
Room temperature control with Open Window Detection: Yes  
Adaptive Start with electronic room temperature control plus week timer: Yes

# TROUBLESHOOTING

PROBLEM	CAUSE	SOLUTION
NO POWER TO FIRE	Electrical lead not plugged in	Check lead in plugged in securely and p-clipped in place
	Circuit board	Replacement part required
	Main socket	Check socket is switched on
NO LIGHTING OR ILLUMINATION	Dimmer turned down	Use remote or app to adjust the dimmer settings
	LED failure	Replacement part required
LED FLICKERING	LED cable connections	Ensure all connections are secure and fully in place
	Damaged cable	Replacement part required
	Faulty LED	Replacement part required
FLAME ILLUMINATED WITHOUT MOVEMENT	Spindle	Check spindle is securely attached to the motor
	Motor	New Motor maybe required
LOGS NOT FULLY ILLUMINATED ACROSS THE FIRE	Log wiring & connectors	Remove glass; check each log is tightly connected together
	Log LED	Replacement log maybe required
	Fuel bed LED	Replacement part required
HEATER BLOWING COLD AIR	The safety cut out may have operated	Check for obstruction around the heater. If continually a problem and fitted into a cavity wall or chimney breast, check with installer that the opening has been 100% fully sealed from drawn air and draft
HEATER NOT COMING ON AT ALL	Thermostat is set to low	Use the remote or app to increase the temperature
HEAT TURNS OFF QUICKLY AFTER TURNING ON	Thermostat is set to low	Use the remote or app to increase the temperature

# TROUBLESHOOTING

PROBLEM	CAUSE	SOLUTION
REMOTE CONTROL NON RESPONSIVE	Lost connection to fire	Turn fire off & on using the rocker switch
	Batteries	Replace with 2 x AAA
GLOWING LOGS NOT WORKING	Poor connection	Check all connections are secure
	Damaged cable	Replacement part required
	LED faulty	Replacement part required
	Lights turned down	Use app or remote to turn lighting up
RHYTHMIC TICKING	Cable loose	Make sure all flame effect LED's are tied back to the LED bar and out the way of the spindle.
CAN NOT PAIR FIRE	Space after email	Remove space from email
	Wrong Wi-Fi password	Check password entered correctly
	No 2.4ghz required network available	Check 2.4GHz internet connection. Restart Router

# WIRING DIAGRAM

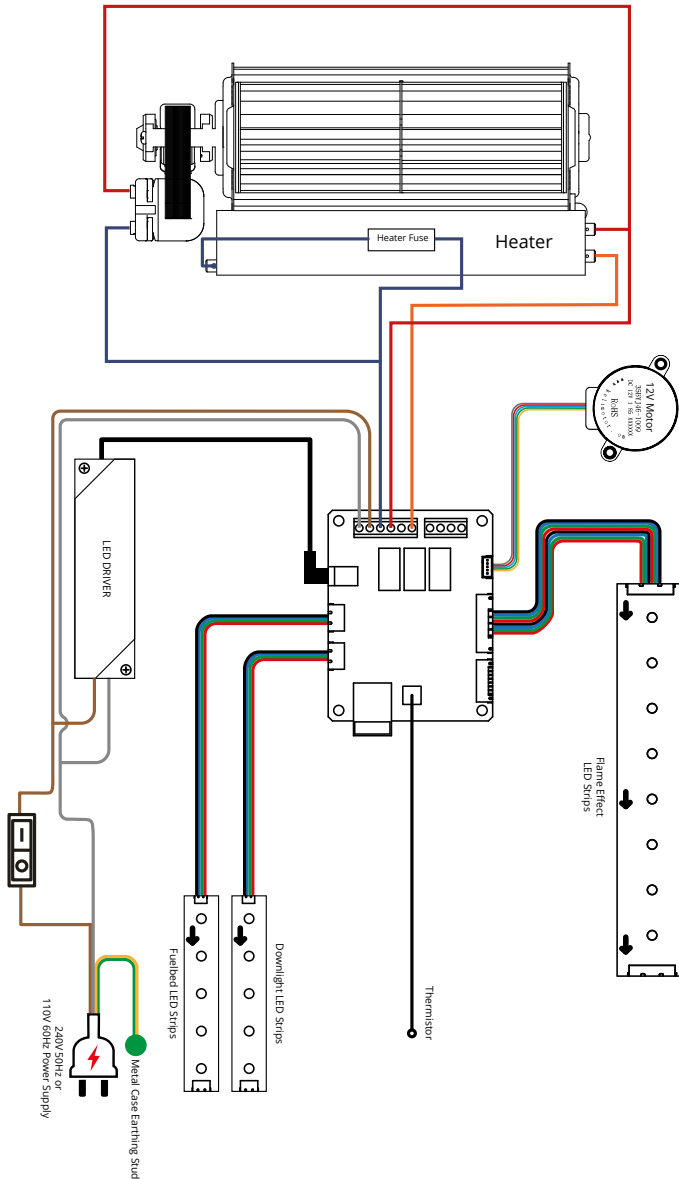

---

## CLEANING

- To clean your fire make sure the power is off at the circuit breaker and the heater is cool before cleaning.
- Wipe with a clean dry cloth that is free from lint and dust. Do not use cleaning chemicals or abrasives.
- Check the heater is free from any dust by wiping the surface with a clean dry cloth. This should be done weekly at a minimum.
- All other servicing should be performed by a qualified service personnel

## MAINTENANCE

### WARNING!

Before any wiring work is undertaken, make sure the power for the socket has been turned off at the fuse box and check that the power is off.

Make sure the unit is disconnected from any power source. Ensure proper safety precautions are taken before attempting any work.



Maintenance **MUST** be undertaken by a qualified technician. Please contact your local retailer where you purchased the fire from.

# EXPLODED DIAGRAM

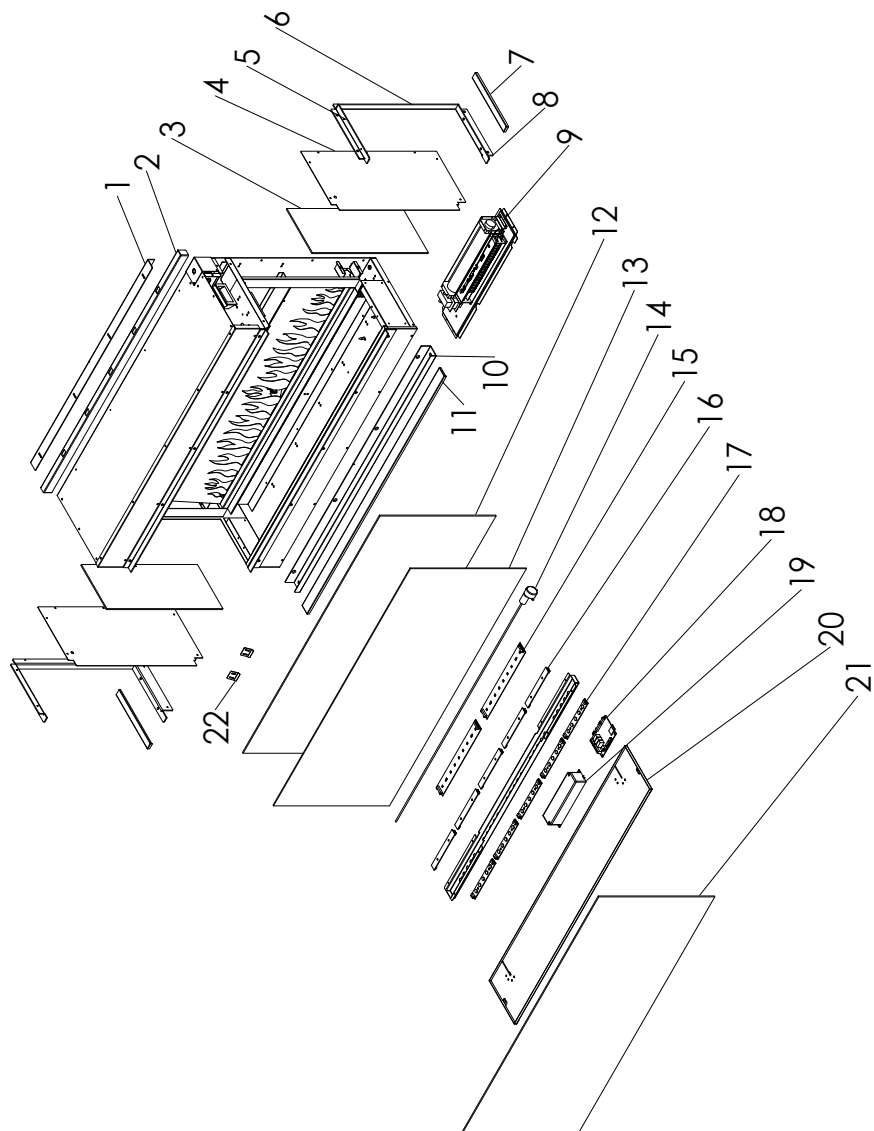



# PARTS LIST

E-FX			
PART NUMBER	PART NAME	PART NUMBER	
1	Top Hanging Rail	12	Rear Screen
2	Heater Decorative Rail	13	Rear Glass
3	Side Glass	14	Spindle Motor
4	Blanking Panel	15	Flame LEDs
5	Top Trim	16	Downlight 150mm LED's
6	Side Trim	17	Fuel bed 150mm LEDs
7	Side Decorative Trim	18	Control Board
8	Bottom Trim	19	Power Driver
9	Heater	20	Fuel bed Tray
10	Bottom Hanging Rail	21	Front Glass
11	Front Decorative Strip	22	Front Glass Brackets

---

# NOTES

---

# NOTES



[www.flameritefires.com/efx](http://www.flameritefires.com/efx)

Flamerite Fires International Ltd, Lichfield Road Industrial Estate, Staffordshire B79 7UL  
Tel: +44 1543 251122 | Email: [info@flameritefires.com](mailto:info@flameritefires.com)

**These products are only suitable for well insulated spaces or occasional use.**

Manufactured in the United Kingdom. All products are protected by patents, registered design and intellectual property rights. Flamerite Fires International Ltd. will protect these rights. All specifications are correct at the time of publishing but are subject to change.

