



E-FX SL INSTALLATION, PRECAUTIONS & SERVICING



www.flameritefires.com/efx

Flamerite Fires International Ltd, Lichfield Road Industrial Estate, Staffordshire B79 7UL
Tel: +44 1543 251122 | Email: info@flameritefires.com

These products are only suitable for well insulated spaces or occasional use.

Manufactured in the United Kingdom. All products are protected by patents, registered design and intellectual property rights. Flamerite Fires International Ltd. will protect these rights. All specifications are correct at the time of publishing but are subject to change.



Version 2

AUGUST 2025

IMPORTANT INFORMATION

- Please bear in mind the weight of the fire before removing from the packaging and installation.
- Consider if help is required.
- Carefully remove the fire from the packaging, making sure that the power cable and heater have not been damaged during transport.
- **DO NOT** operate the fire if damaged.
- The accessories are found in a box that is packed at the side of the fire.
- Always read this manual first before attempting to install or use and keep in a safe place.
- Your fire is guaranteed for three years from the date of purchase.*
- *Northern Ireland - 1 Year
- 2.4GHz Network Required



 **SAVE THESE INSTRUCTIONS**

CONTENTS

Contents.....	4
Important Instructions	5
UKCA & CE Declarations	8
Details	9
Technical Specifications	10
Required Tools.....	11
What's In The Box.....	12
Before You Start	13
Flat Wall Installation.....	14
Rear Screen Options.....	17
Front Glass Installation.....	18
Informational Requirements	19
Maintenance & Cleaning	20
Trouble Shooting.....	21
Wiring Diagram.....	23
Parts List.....	24
Exploded Diagram.....	25
Notes.....	26

IMPORTANT INSTRUCTIONS

IMPORTANT

REGISTRATION NO WEE/DH1656ZW

- In accordance with European Directive 2012/19/ EU, waste electrical and electronic equipment (WEEE) must not be disposed of with household waste.
- Please recycle responsibly.



DETAILS

- Read all the instructions before installing or using this heater.
- **WARNING:** In order to avoid overheating, do not cover the heater.
- For indoor use only.
- **DO NOT** use the fire in the vicinity of a bath, shower or swimming pool.
- **NEVER** use the fire to dry laundry.
- The heater must not be located immediately below a socket outlet.
- The use of an extension lead is **NOT** recommended.
- This appliance can be used by children aged from 8 years and above and persons with reduced physical, sensory or mental capabilities or lack of experience and knowledge if they have been given supervision or instruction concerning use of the appliance in a safe way and understand the hazards involved.
- Children shall **NOT** play with the appliance.

IMPORTANT INSTRUCTIONS

- Cleaning and user maintenance shall **NOT** be made by children without supervision.
- Children of less than 3 years should be kept away unless continuously supervised.
- Children aged from 3 years and less than 8 years shall only switch on/off the appliance provided that it has been placed or installed in its intended normal operating position and they have been given supervision or instruction concerning use of the appliance in a safe way and understand the hazards involved.
- Children aged from 3 years and less than 8 years shall not plug in, regulate and clean the appliance or perform user maintenance.
- Some parts of this product can become very hot and cause burns. Particular attention must be given where children and vulnerable people are present.
- The heater is hot when in use. To avoid burns, do not let bare skin touch hot surfaces. Keep combustible materials, such as furniture, pillows, bedding, paper, clothes, etc. and curtains at least 3 feet (0.9m) from the front of the heater and keep them away from the sides and rear (sides and rear restrictions apply to location dedicated heaters only).
- Extreme caution is necessary when any heater is used by or near children or invalids and whenever the heater is left operating and unattended.
- Do not operate any heater after it malfunctions. Disconnect power at service panel and have heater inspected by a reputable electrician before reusing.
- Do not use outdoors.
- To disconnect heater, turn controls to off and turn off power to heater circuit at main disconnect panel.
- Do not insert or allow foreign objects to enter any ventilation or exhaust opening as this may cause an electric shock or fire, or damage to the heater.
- To prevent a possible fire, do not block air intakes or exhaust in any manner.
- A heater has hot and arcing or sparking parts inside. Do not use it in areas where gasoline, paint, or flammable vapours or liquids are used or stored.
- Use this heater only as directed in this manual. Any other use not recommended by the manufacture may cause fire, electric shock, or injury to persons.

IMPORTANT INSTRUCTIONS



CAUTION

**CAUTION
RISK OF ELECTRIC SHOCK
DO NOT OPEN
NO USER-SERVICEABLE PARTS INSIDE**



- The heater must be properly installed before it is used.
- Caution should be applied to ensure that children **DO NOT** play with the fuel effects.
- As with any electrical appliance whilst the instructions aim to cover as many eventualities as possible, caution and common sense should be applied when operating your appliance, particularly in the vicinity of small children.
- **CAUTION:** The heater is fitted with an automatic cut out to prevent any damage due to overheating. The element will

continually and automatically cut out if the airflow is obstructed. Never cover the air outlets. To reset, switch the fire off, disconnect from the main supply, remove the cause of the overheating. Allow to cool for a suitable period then switch the fire back on.

- **CAUTION:** In order to avoid a hazard due to inadvertent resetting of the thermal cut out, the appliance must not be supplied through an external switching device, such as a timer, or connected to a circuit regularly switched on and off by a utility.

UKCA & CE DECLARATIONS

TRADE NAME	RATINGS	PRODUCT TYPE	MANUFACTURED BY
E-FX	220-240 Vac, 50Hz Class I	Electric Fire (fan heater) (5120 BTU)	Flamerite Fires International Ltd, Lichfield Road Industrial Estate, Staffordshire B79 7UL United Kingdom
REQUIREMENTS:			
BS-EN 60335-2-30:2009 + A11:2012			
BS-EN 60335-1:2012 + A11:2014 + A13:2017 + A1:2019 + A14:2019 + A2:2019			
BS-EN 55014-1:2017		BS-EN IEC 6300 :2018	
BS-EN 55014-2:2015		BS-EN 301 489-1	
BS-EN61000-3-2:2014		BS-EN 300 489-3	
BS-EN 61000-3-3:2013		BS-EN 300 220	
BS-EN 50564:2011		BS-EN 60675:1995+A11:2019	

TRADE NAME	RATINGS	PRODUCT TYPE	MANUFACTURED BY
E-FX	220-240 Vac, 50Hz Class I	Electric Fire (fan heater) (5120 BTU)	Flamerite Fires International Ltd, Lichfield Road Industrial Estate, Staffordshire B79 7UL United Kingdom
REQUIREMENTS:			
EN 60335-2-30:2009 + A11:2012			
EN 60335-1:2012 + A11:2014 + A13:2017 + A1:2019 + A14:2019 + A2:2019			
EN 55014-1:2017		EN IEC 6300 :2018	
EN 55014-2:2015		EN 301 489-1	
EN61000-3-2:2014		EN 300 489-3	
EN 61000-3-3:2013		EN 300 220	
EN 50564:2011		EN 60675:1995+A11:2019	

DETAILS

- A 120V 15A 60Hz or 240V 13A 50Hz supply is required.
- Maximum Power Consumption: 1500 Watts
- A 1.8 metre / 6 foot lead with plug is supplied with this appliance
- There must be enough clearance for the fire to comfortably fit inside or against a wall.
- **DO NOT** squeeze into an opening as this may deform the case and stop the glass from moving correctly.
- The fire must be well supported in or on any structure. Never secure to just plaster board alone.
- A wall support or lintel should be fitted at the required height to ensure the appliance does not support the weight of the finished wall or chimney breast.

WARNING

DO NOT twist, force or squeeze the fire during the installation process.

TECHNICAL SPECIFICATIONS

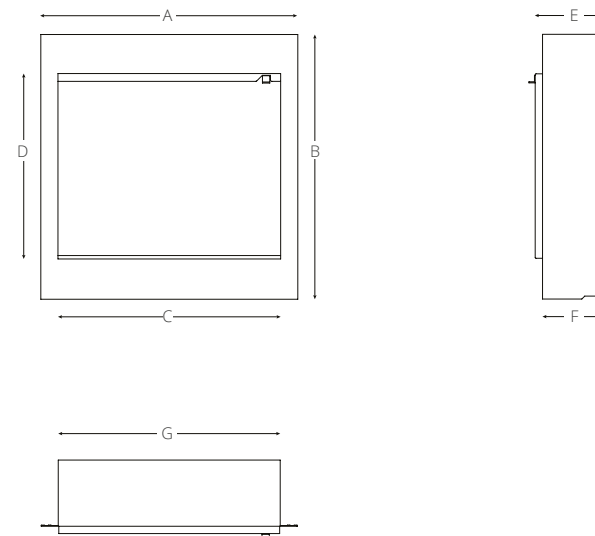

E-FX MODEL					
	E-FX SL600 - 24"	E-FX SL750S - 30S"	E-FX SL750T - 30T"	E-FX SL1000 - 40"	
DIMENSIONS	A	700mm / 27 9/16"	850mm / 33 7/16"	850mm / 33 7/16"	1100mm / 43 5/16"
	B	721mm / 28 3/8"	631mm / 24 13/16"	876mm / 34 1/2"	572mm / 22 1/2"
	C	605mm / 23 13/16"	755 mm / 29 3/4"	755 mm / 29 3/4"	1005mm / 39 9/16"
	D	502mm / 19 3/4"	413mm / 16 1/4"	658mm / 25 15/16"	353mm / 13 7/8"
	E	201mm / 7 15/16"	201mm / 7 15/16"	201mm / 7 15/16"	201mm / 7 15/16"
	F	178mm / 7"	178mm / 7"	178mm / 7"	178mm / 7"
	G	607mm / 23 7/8"	756mm / 29 3/4"	756mm / 29 3/4"	1006mm / 39 5/8"
	KG	22KG / 48.5lbs	25KG / 55.1lbs	28KG / 61.7lbs	28KG / 61.7lbs

REQUIRED TOOLS



HAMMER &
SCREWDRIVER



DRILL &
DRILL BITS



TAPE MEASURE



PENCIL

WHAT'S IN THE BOX...

01

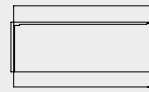

E-FX FIRE

02



LOG SET

03

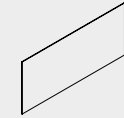

FRONT GLASS

04



ACCESSORY PACK

05



INSTRUCTIONS

06

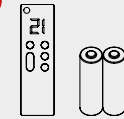

REMOTE &
BATTERIES

07



FIXING PACK

BEFORE YOU START...

PLUG SOCKETS & WALL CONSTRUCTION

All fires must have an accessible plug. Do not fit a fire above a socket. Building regulations require the socket to be located at the side of the unit. It is preferable to fit the fire to a grounded outlet for safety. This makes sure it will not overload current installations and the power can be turned off when required.

IMPORTANT

Please speak with a qualified expert before undertaking any work and if required ask them to carry out the installation for you. Due to the nature of this product precautions to fireproof the wall should be taken according to local legislations. Make sure airflow is allowed around the fire by leaving at least 5mm of room around all sides of the fire.

The cord has a plug as shown in Figure A. An adapter shown at B is available for connecting three-blade grounding type plugs in two slot receptacles. The grounding lug extending from the adapter must be connected to a permanent ground such as a properly grounded outlet box. The adapter should not be used if a three-slot grounded receptacle is available.

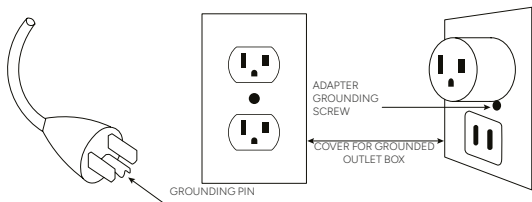
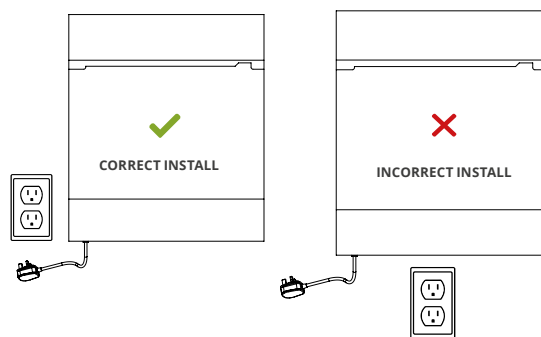

FIGURE A

FIGURE B

FLAT WALL INSTALLATION

01

Start by building the framework for the wall. The sizes are listed in the table below for your fire. We recommend installing the grounded outlet at this stage in the position shown below so power to the fire is easily accessible. You can choose the height your fire is fitted to the wall, but take any local building regulations into account.

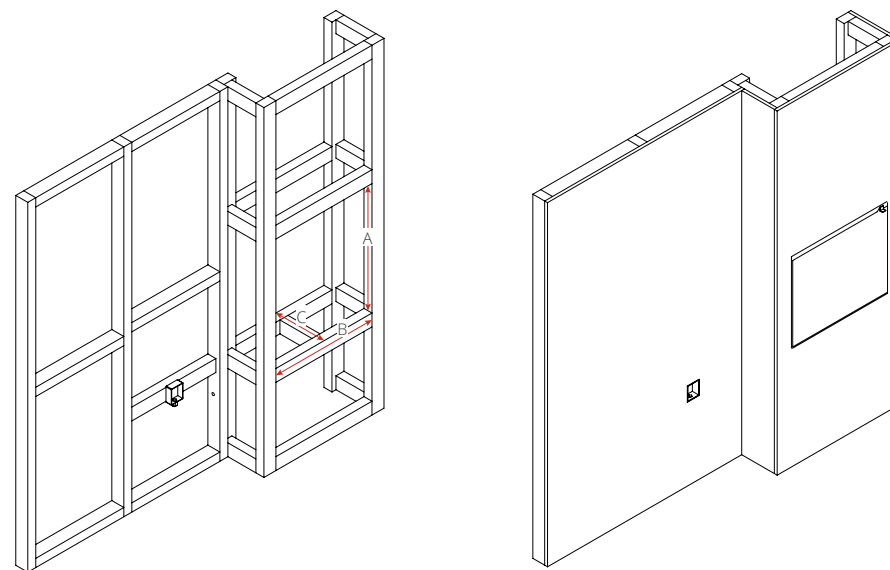

E-FX MODEL					
		E-FX SL600 - 24"	E-FX SL750S - 30S"	E-FX SL750T - 30T"	E-FX SL1000 - 40"
DIMENSIONS	A	725mm / 28 9/16"	635mm / 25"	880mm / 34 5/8"	575mm / 22 5/8"
	B	610mm / 24 1/16"	760mm / 29 15/16"	760mm / 29 15/16"	1010mm / 39 3/4"
	C	180mm / 7 1/16"	180mm / 7 1/16"	180mm / 7 1/16"	180mm / 7 1/16"

FLAT WALL INSTALLATION

02

Now the framework and sockets are installed you can attach your fire to the frame. Be sure you plug anything in before you start to add any panel work. Attach the fire to the framework using the correct fixings. If you are fixing to a timber frame, use the gold 2" screws that come in the fixing pack, found in the accessory pack. Be sure to use suitable fixings for the material you are attaching to.

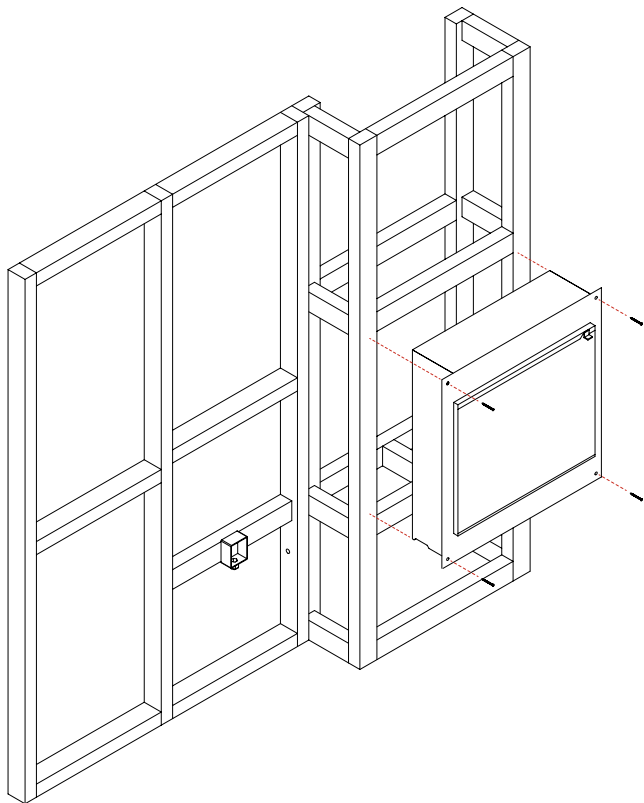

FLAT WALL INSTALLATION

03

Now the fire is installed you can attach the panels the wall. Make sure everything is working before you do this step so that any issues can be sorted before plastering or any finishing takes place. The height from the floor will depend on the install height. See the below table for cut-outs for the front panel. Be sure to double check all dimensions against the actual fire to get the most accurate cut-out you can.

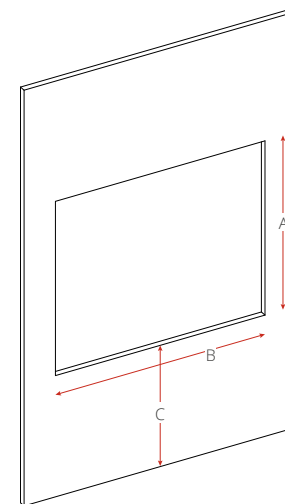

E-FX MODEL				
	E-FX SL600 - 24"	E-FX SL750S - 30S"	E-FX SL750T - 30T"	E-FX SL1000 - 40"
DIMENSIONS				
A	725mm / 28 9/16"	635mm / 25"	880mm / 34 5/8"	575mm / 22 5/8"
B	610mm / 28 3/8"	760mm / 29 15/16"	760mm / 29 15/16"	1010mm / 39 3/4"
C	Variable	Variable	Variable	Variable

FLAT WALL INSTALLATION

04

Screw the panelling to the framework and make sure everything lines up and is working. We recommend using 15-18mm or 9/16" - 11/16" finishing boards. This is so you can apply any finishes such as plaster coatings or decorative panelling.

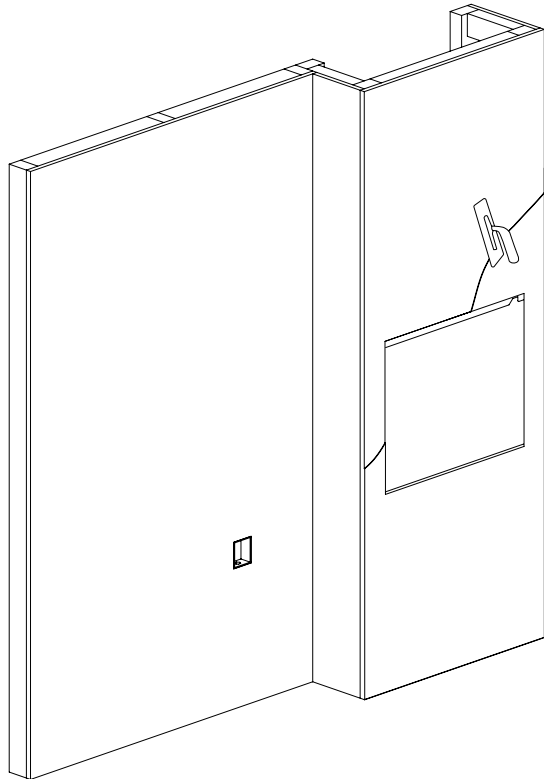

FRONT GLASS INSTALLATION

01

To install the front glass, first clean the glass with a soft clean cloth and make sure it is free from dust and residue.

Using the glass suction cup provided, lift the front glass into position, making sure the bottom edge sits between the fuelbed and front lip.

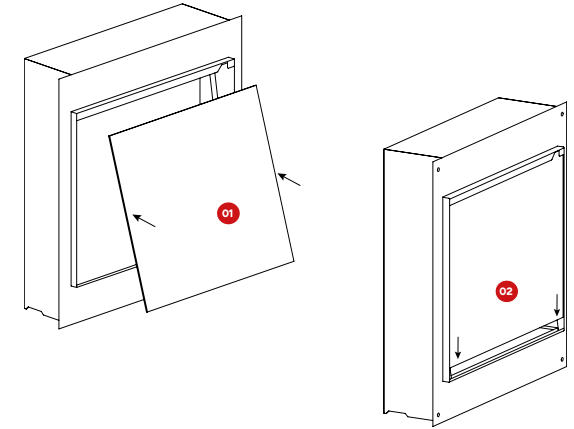

INFORMATIONAL REQUIREMENTS

E-FX SL

E-FX SL: INFORMATIONAL REQUIREMENTS FOR ELECTRIC LOCAL SPACE HEATERS						
MODEL		SL600 - 24"	SL750 S- 30"	SL750T - 30"	SL1000 - 40"	
Item @ 120V 60Hz or 240V 50Hz	Symbol	Value	Value	Value	Value	Unit
HEAT OUTPUT						
Nominal Heat Output	Pnon	1.5	1.5	1.5	1.5	kW
Minimum Heat Output (Indicative)	Pmin	0.75	0.75	0.75	0.75	kW
Maximum Continuous Heat Output	PMax,c	1.5	1.5	1.5	1.5	kW
AUXILIARY ELECTRICITY CONSUMPTION						
At Normal Heat	elmax	0.0151	0.0253	0.0253	0.0279	kW
At Minimum Heat	elmin	0.0151	0.0253	0.0253	0.0279	kW
In Standby Mode	elSB	0.0005	0.0005	0.0005	0.0005	kW

With Distance Control: Yes
 Room temperature control with open window detection: Yes
 Adaptive Start With electronic room temperature control plus week timer: Yes

MAINTENANCE & CLEANING

WARNING!

Before any wiring work is undertaken, make sure the power for the socket has been turned off at the fuse box and check that the power is off.

Make sure the unit is disconnected from any power source. Ensure proper safety precautions are taken before attempting any work.



Maintenance **MUST** be undertaken by a qualified technician.

Please contact your local retailer where you purchased the fire from.

- To clean your fire, make sure the power is off at the circuit breaker and the heater is cool before cleaning.
- Wipe with a clean dry cloth that is free from lint and dust. Do not use cleaning chemicals or abrasives.
- Make sure the heater is free from any dust by wiping the surface with a clean dry cloth. This should be done weekly at a minimum.
- All other servicing should be performed by a qualified service personnel.

TROUBLE SHOOTING

PROBLEM	CAUSE	SOLUTION
NO POWER TO FIRE	Circuit board	Replacement part required
	Main socket	Check socket is switched on
NO LIGHTING OR ILLUMINATION	Dimmer turned down	Use remote or app to adjust the dimmer settings
	LED failure	Replacement part required
LED FLICKERING	Led cable connections	Ensure all connections are secure and fully in place
	Damaged cable	Replacement part required
	Faulty led	Replacement part required
FLAME ILLUMINATED WITHOUT MOVEMENT	Spindle	Check spindle is securely attached to the motor
	Motor	New Motor maybe required
LOGS NOT FULLY ILLUMINATED ACROSS THE FIRE	Log wiring & connectors	Remove glass; check each log is tightly connected together
	Log led	Replacement log maybe required
	Fuel bed led	Replacement part required
HEATER BLOWING COLD AIR	The safety cut out may have operated	Check for obstruction around the heater. If continually a problem and fitted into a cavity wall or chimney breast, check with installer that the opening has been 100% fully sealed from drawn air and draft
HEATER NOT COMING ON AT ALL	Thermostat is set to low	Use the remote or app or keypad to increase the temperature
HEAT TURNS OFF QUICKLY AFTER TURNING ON	Thermostat is set to low	Use the remote or app or keypad to increase the temperature
FRONT GLASS WILL NOT FIT	Debris is front channel	Remove any obstructions and fit

TROUBLE SHOOTING

PROBLEM	CAUSE	SOLUTION
REMOTE CONTROL NON RESPONSIVE	Lost rf connection to fire	Turn fire off & on using the rocker switch next to keypad and re-pair the remote. See App instructions.
	Batteries	Replace with 2 x AAA
GLOWING LOGS NOT WORKING	Poor connection	Check all connections are secure
	Damaged cable	Replacement part required
	LED faulty	Replace faulty log(s)
RHYTHMIC TICKING	Cable loose	Make sure all flame effect LED's are tied back to the LED bar and out the way of the spindle.
CAN NOT PAIR FIRE	Space after email	Remove space from email
	Wrong wi-fi password	Check password
	No 2.4ghz network available	Check 2.4GHz internet connection

WIRING DIAGRAM

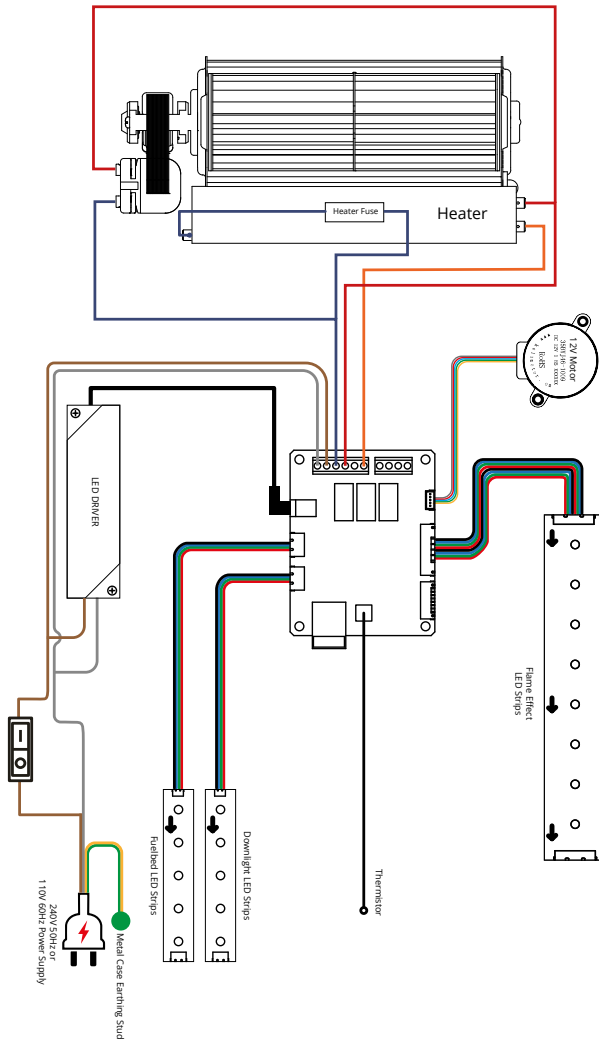

PARTS LIST

PART NUMBER	PART NAME	E-FX			
		SL600 (24")	SL750S (30")	SL750T (30")	SL1000 (40")
1	Power Lead	E90-2	E90-2	E90-2	E90-2
2	Spindle Motor	E99	E99	E99	E99
3	Spindle	M134	M135	M135	M136
4	280mm LED	E76	E76	E76	E76
5	Rear Projection Screen	FE225	FE226	FE227	FE228
6	150mm LED	E3	E3	E3	E3
7	PCB Board	E50	E50	E50	E50
8	LED Driver	E42	E42	E42	E42
9	Fuel Bed Tray	FE219	FE221	FE221	FE223
10	Front Glass	G46	G48	G49	G50
11	Power Switch	E77	E77	E77	E77
12	Heater	E16-1	E16-1	E16-1	E16-1
13	Remote	E47-2	E47-2	E47-2	E47-2
14	Glass Suction	C112	C112	C112	C112

EXPLODED DIAGRAM

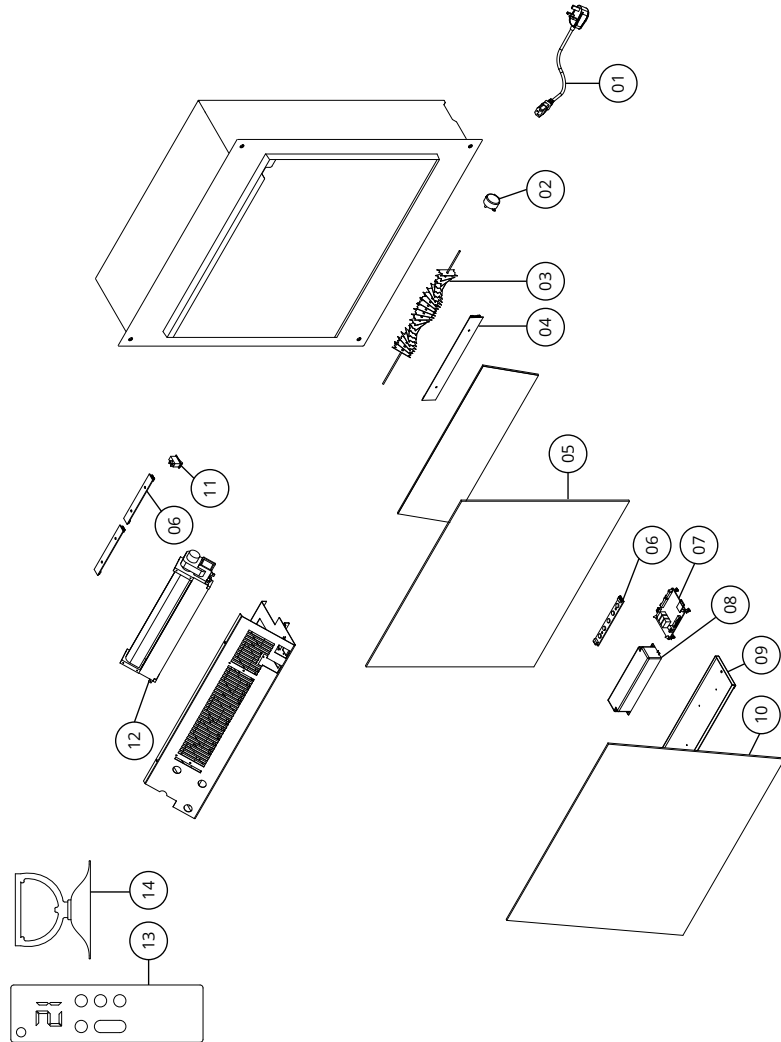

NOTES

A series of horizontal dotted lines for taking notes.

NOTES

A series of horizontal dotted lines for writing notes.

NOTES

A series of horizontal dotted lines for writing notes.